

M.G.A. ZONE 56 M.G.A. DATUM: GDA94

- DESIGNER AND WATER SERVICING COORDINATOR:
QALCHEK PTY LTD (CERTIFIED No.289)
UNIT 2, 15-17 DAVID RD EMU PLAINS NSW 2750
PH. No. (02) 4722 8181

FOR:
LEGPRO PTY LTD ATF LEGPRO 54 PTY LTD
LEVEL 27 - 19-29 MARTIN PLACE SYDNEY N.S.W 2000
PH: 92521111
- THE WORKS AND MATERIALS ARE IN ACCORDANCE WITH THE SEWERAGE CODE OF AUSTRALIA WSA 02-2002-2.2 SYDNEY WATER EDITION VERSION 4 (2017) INCLUDING THE SYDNEY WATER SUPPLEMENT & APPENDICES.
- ALL STRUCTURES ARE CONSTRUCTED TO FINISHED SURFACE LEVELS.
ALL LEVELS REFER TO FINISHED SURFACE LEVEL.
- ALL BUILDING LAYOUTS, FINISHED SURFACE LEVELS, STORMWATER INFORMATION, AND GENERAL CIVIL ENGINEERING DETAILS TAKEN FROM J.WYNDHAM PRINCE ENGINEERING PLANS REFERENCE DRAFT PLANS 110358/CC704 REVISION 'A' DATED '11-12-2018'
- THE NUMBER OF FIELD COMPACTION TESTS CONDUCTED TO SATISFY THE SEWERAGE CODE OF AUSTRALIA ARE:

PIPE EMBEDMENT ZONE: 0 TESTS CONDUCTED (LETTER PROVIDED)
TRENCH FILL ZONE (TRAFFICABLE): 0 TESTS CONDUCTED (LETTER PROVIDED)
TRENCH FILL ZONE (NON TRAFFICABLE): 20 TESTS CONDUCTED
TRENCH FILL ZONE (MAINTENANCE STRUCTURES): 72 TESTS CONDUCTED
TRENCH FILL ZONE - TOTAL: 92 TESTS CONDUCTED
- BUILDING OVER/ADJACENT TO SEWER - CONDITIONS MAY APPLY. REFER TO QALCHEK FOR DETAILS.
- ALL EXCAVATION, SHORING EXCAVATION AND STABILITY OF ADJACENT STRUCTURES/SERVICES/DWELLINGS WAS THE RESPONSIBILITY OF THE CONSTRUCTOR.
- ALL PCS CONNECTIONS TO I.S. ARE AT 0.7m & 45° TO MAIN UNLESS OTHERWISE INDICATED.
- DENOTES STANDARD PCS CONNECTION (REFER DTC-2120 ISSUE A DATE 18.03.15)
- THE WORKS ARE CONSTRUCTED IN ACCORDANCE WITH SYDNEY WATER'S DEEMED TO COMPLY DRAWINGS:
- FOR ALL MH'S
DTC-2000 (ISSUE C 18-03-15),
DTC-2220 (ISSUE D 18-03-15),
DTC-2221 (ISSUE B 01.03.13),
DTC-2222 (ISSUE C 18-03-15),
DTC-2203 (ISSUE B 18-03-15)
- PIPES CONCRETE ENCASED SHOWN ACCORDINGLY:- REFER TO SEW-1205-V
- AREAS HATCHED THUS NOT DRAINED:-
- ALL M.S.'s CONFORM TO WSA-137, "INDUSTRY STANDARD FOR MAINTENANCE SHAFTS AND MAINTENANCE CHAMBERS FOR SEWERAGE".
- BULKHEADS CONSTRUCTED AT EACH KERB CROSSING/EDGE OF BITUMEN CROSSING TO SEW-1206. THIS APPLIES TO ANY ACCESS ROADS, CARPARKS, ETC.
- W.A.C. PREPARED FROM INFORMATION SUPPLIED BY QALCHEK PTY LTD.

* DENOTES SERVICED BY CN163828WW
● DENOTES ELECTRICAL SUBSTATION SITE

SHEET 2

LOCALITY SKETCH
(NOT TO SCALE)

0	WORK AS CONSTRUCTED	J.V.	14.05.20
E	SYDNEY WATER CHANGES	M.P	08.10.19
D	STEEP GRADES REDUCED	M.P	10.09.19
C	NOTE 12 OFFSET CHANGED TO 1M	M.P	19.07.19
B	LOT LAYOUT REVISED	M.P	08.11.18
A	DRAFT	M.P	02.11.18
No.	AMENDMENT DESCRIPTION	BY	DATE

PLAN TO BE READ IN CONJUNCTION WITH CURRENT SYDNEY WATER STANDARDS SYDNEY WATER CORPORATION

PRIOR TO COMMENCEMENT OF EXCAVATION FOR PROPOSED AND EXISTING SERVICES CONTACT:-
DIAL BEFORE YOU DIG Ph. 1100
ELECTRICITY Ph.
GAS Ph.
TELECOMMUNICATIONS Ph.
SYDNEY WATER Ph. 132 092
GIVING AT LEAST 48 HOURS NOTICE.

UTILITIES		DATE		REF.	
TYPE	DATE	REF.	TYPE	DATE	REF.
WATER: DN100 Water	Dec'18	Qalchek	S.S.M 204706	Dec'18	SCIMS
STORMWATER: SWD	Dec'18	Jwp			
TELSTRA: TEL	Feb '19	DBYD			
GAS: G(HP)	Feb '19	DBYD			
GAS: G(LP)	Feb '19	DBYD			
ENERGY AJUST: E	Feb '19	DBYD			

WORK AS CONSTRUCTED CERTIFICATION	
DEVELOPER	LEGPRO PTY LTD
WATER SERVICE CO-ORDINATOR	QALCHEK PTY LTD
CONSTRUCTOR	FLUID SERVICES PTY LTD
COMPLETED	11.05.2020
DESIGNER	QALCHEK PTY LTD
W.A.C. PREPARED	14.05.2020
I CERTIFY THAT THE WORKS HAVE BEEN CONSTRUCTED IN ACCORDANCE WITH THE WORK AS CONSTRUCTED DRAWINGS.	

PIPE SCHEDULE				
SIZE DN	TYPE	CLASS	LENGTH	PIPE JOINING METHOD / NOTES
150	U.P.V.C	SN8	623.6	RRJ
100	U.P.V.C	SN10	28.0	SWJ (NOTE 8)
DESIGN HEAD: ... m				
NO BOUNDARY TRAPS REQUIRED.				

AUSTRALIAN HEIGHT DATUM	
SCALES	
PLAN	1:500
SECTION	HOR. : 1:500 VERT. : 1:125
CROSS SECTIONS : NATURAL	
LENGTHS, DEPTHS & LEVELS ARE IN METRES.	

NO AMENDMENTS ARE TO BE MADE TO THIS PLAN WITHOUT REFERENCE TO SYDNEY WATER. THIS PLAN IS NOT NECESSARILY UP TO DATE OR CORRECT AND SYDNEY WATER ACCEPTS NO RESPONSIBILITY.	
U.B. DIRECTORY MAP 184/ K4 SYDNEY (42nd Ed.)	
SHEET . 1 . OF . 4 .	File No. . N/A .

Sydney WATER SYDNEY WATER CORPORATION

Case No. 174096WW

PENRITH SEWERAGE DRAINS TO ST MARYS S.T. 0011

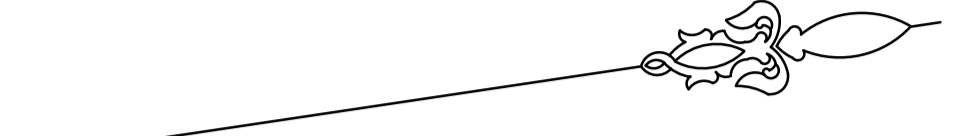
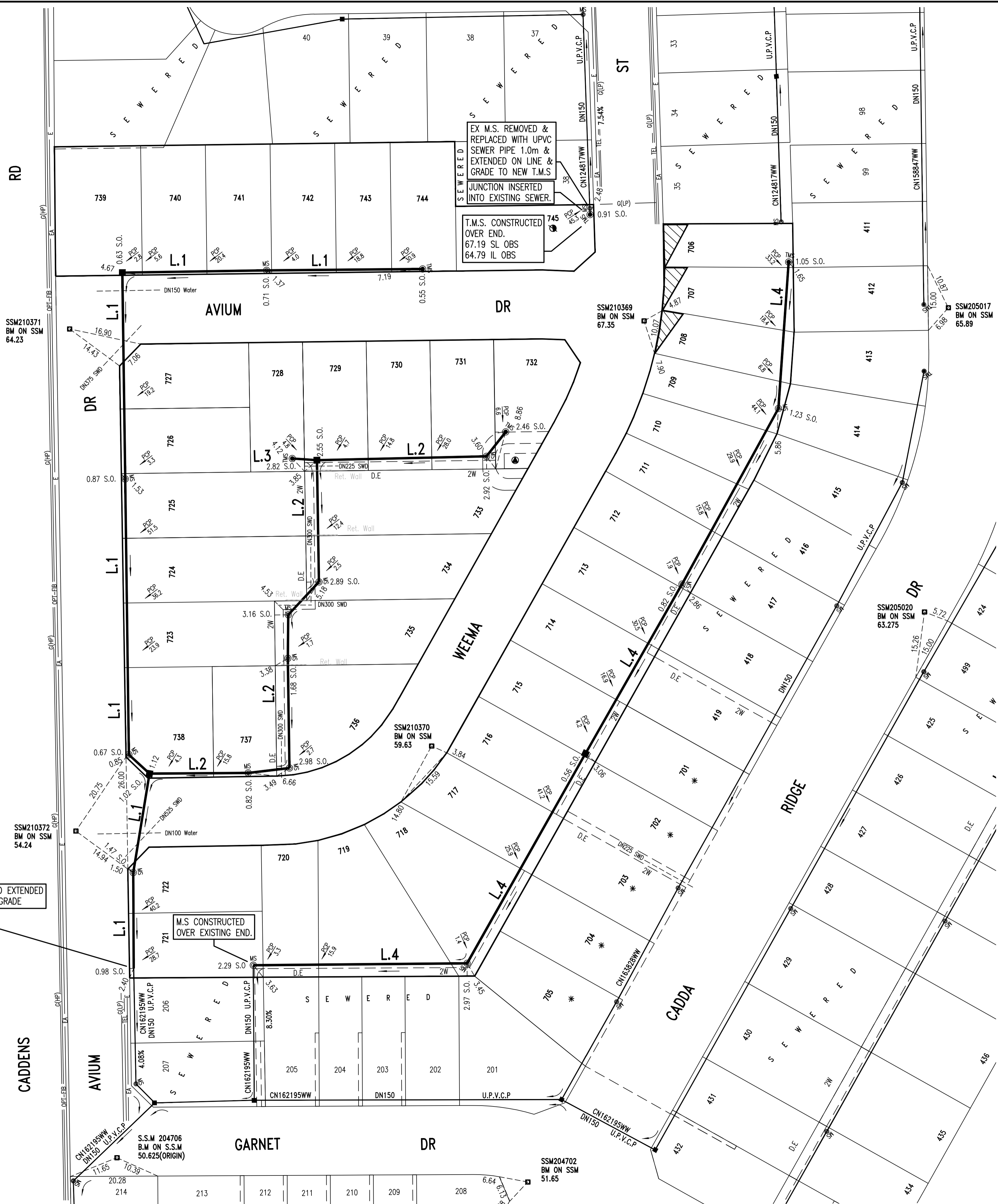

- * DENOTES SERVICED BY CASE 163828WW
- ⊙ DENOTES ELECTRICAL SUBSTATION SITE
- ⊙ DENOTES JUNCTION INSERTED INTO EXISTING SEWER.

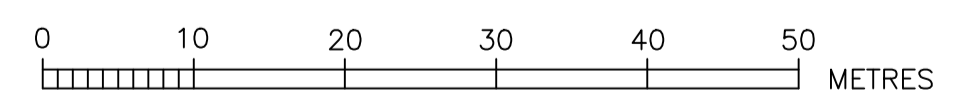

No.	AMENDMENT DESCRIPTION	BY	DATE
0	WORK AS CONSTRUCTED	J.V.	14.05.20
E	SYDNEY WATER CHANGES	M.P.	08.10.19
D	STEEP GRADES REDUCED	M.P.	10.09.19
C	NOTE 12 OFFSET CHANGED TO 1M	M.P.	19.07.19
B	LOT LAYOUT REVISED	M.P.	08.11.18
A	DRAFT	M.P.	02.11.18

WORK AS CONSTRUCTED CERTIFICATION		SYDNEY WATER CORPORATION	
DEVELOPER	LEOPRO PTY LTD	Sydney WATER	
W.S.C.	QALCHEK PTY LTD		
CONSTRUCTOR	FLUID SERVICES PTY LTD	Case No. 174096WW	SHT 2 OF 4 SHTS.
COMPLETED	11.05.2020		
W.A.C. PREPARED	14.05.2020		
DESIGNER	QALCHEK PTY LTD	SYDNEY WATER CORPORATION	
I CERTIFY THAT THE WORKS HAVE BEEN CONSTRUCTED IN ACCORDANCE WITH THE WORK AS CONSTRUCTED DRAWINGS		FOR DETAILS OF SERVICES SEE SHEET 1	

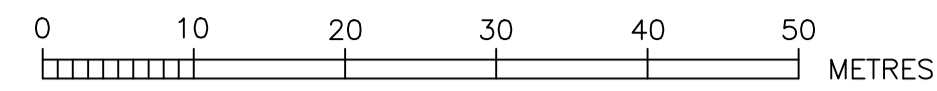

ALL MANHOLES DTC-2203 UNLESS OTHERWISE SHOWN

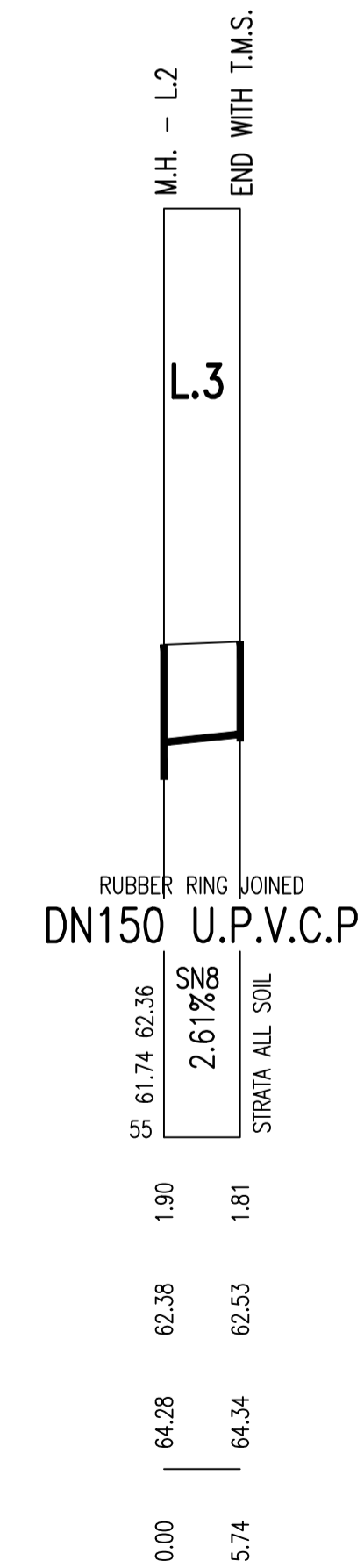
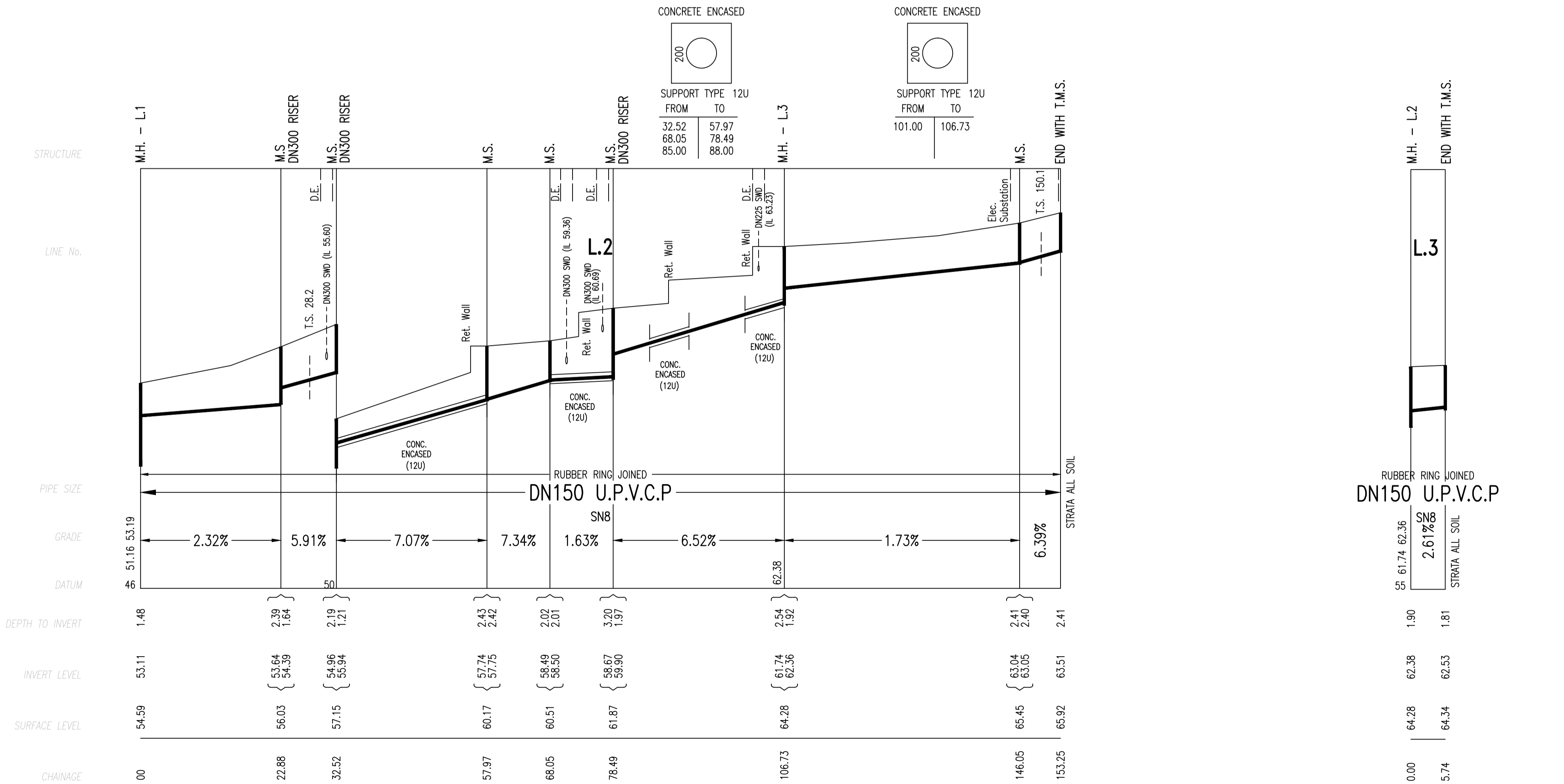
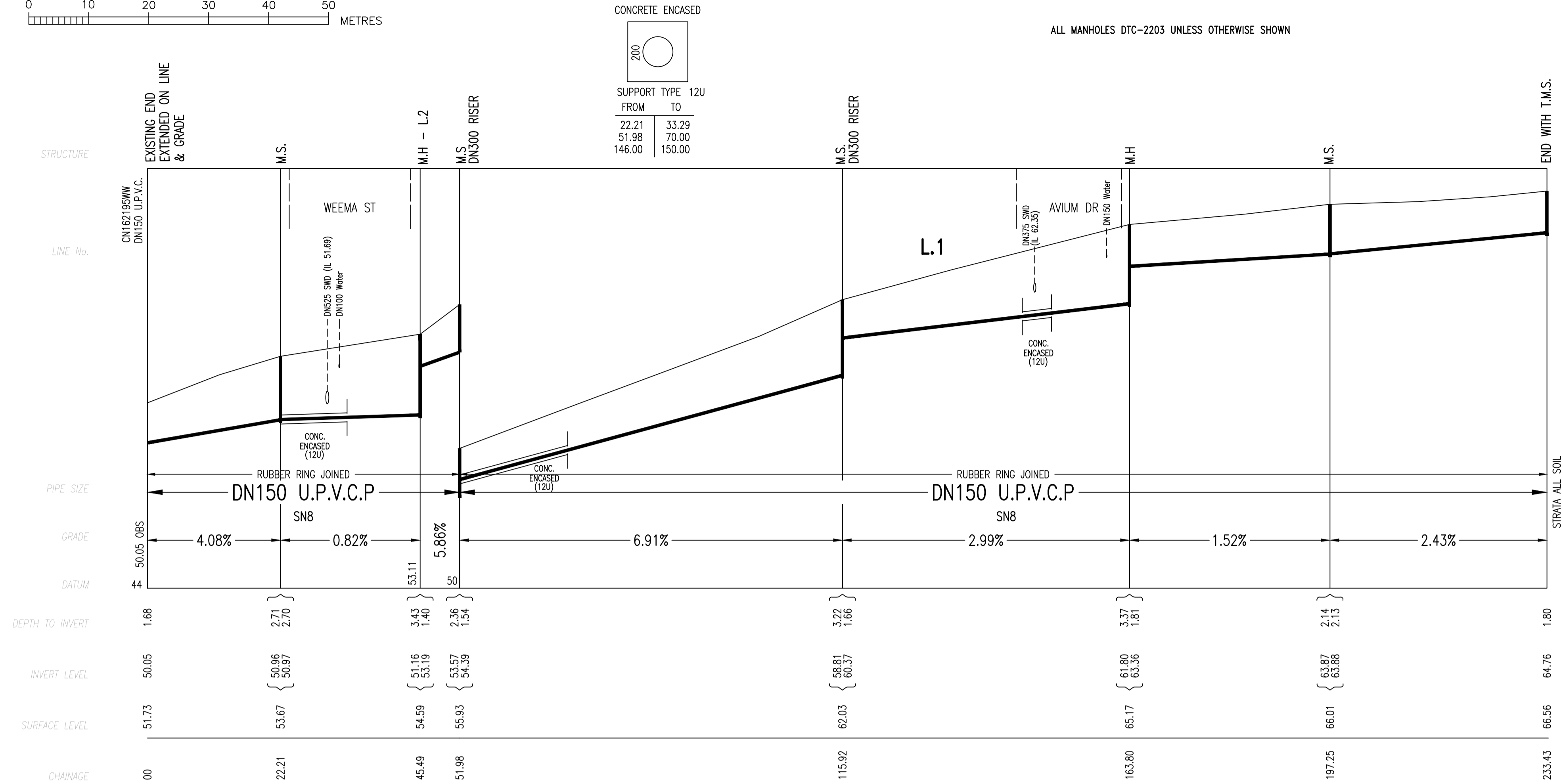

No.	AMENDMENT DESCRIPTION	BY	DATE
0	WORK AS CONSTRUCTED	J.V.	14.05.20
E	SYDNEY WATER CHANGES	M.P	08.10.19
D	STEEP GRADES REDUCED	M.P	10.09.19
C	NOTE 12 OFFSET CHANGED TO 1M	M.P	19.07.19
B	LOT LAYOUT REVISED	M.P	08.11.18
A	DRAFT	M.P	02.11.18

WORK AS CONSTRUCTED CERTIFICATION		SYDNEY WATER CORPORATION	
DEVELOPER	LEGPRO PTY LTD	Sydney WATER	
W.S.C.	QALCHEK PTY LTD		
CONSTRUCTOR	FLUID SERVICES PTY LTD	Case No. 174096WW	SHT 3 OF 4 SHTS.
COMPLETED	11.05.2020	FOR DETAILS OF SERVICES SEE SHEET 1	
W.A.C. PREPARED	14.05.2020		
DESIGNER	QALCHEK PTY LTD	SYDNEY WATER CORPORATION	
I CERTIFY THAT THE WORKS HAVE BEEN CONSTRUCTED IN ACCORDANCE WITH THE WORK AS CONSTRUCTED DRAWINGS		FOR DETAILS OF SERVICES SEE SHEET 1	

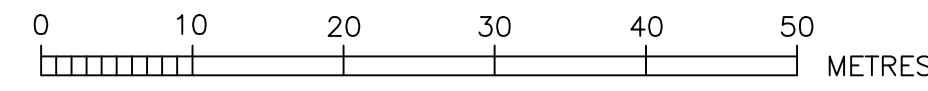

ALL MANHOLES DTC-2203 UNLESS OTHERWISE SHOWN

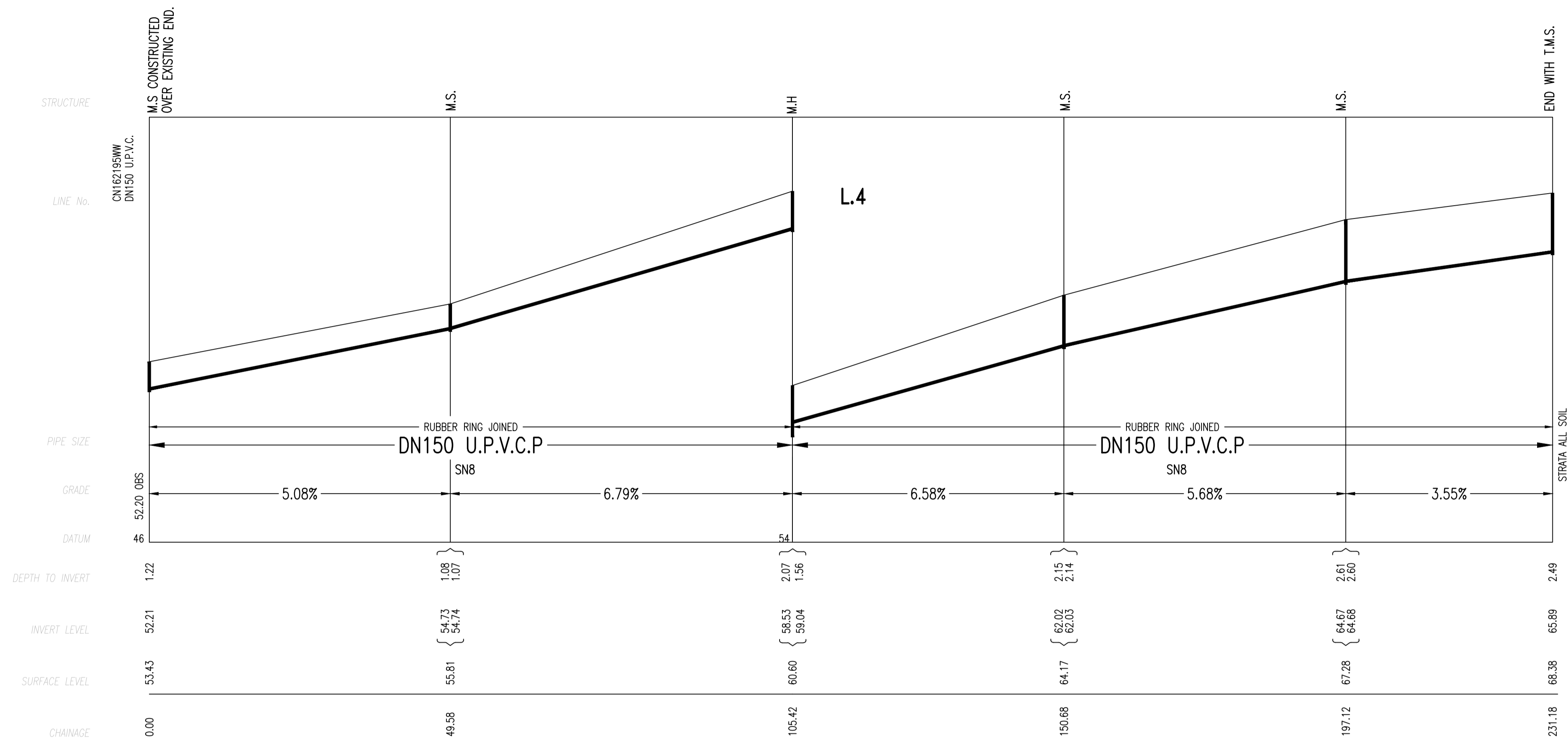

LINE No.	CH. No.	TYPE (MH/MS/MC)	DN RISER	CLASS OF COVER	MATERIAL (PVC-U, PE, PR, GRP, CAST IN SITU CONC, PRE-CAST CONC, OTHER - SPECIFY)	COMMENTS (BRAND/DTC No/ISSUE, DATE/NA, OTHER AS REQUIRED)
1	22.21	M.S.	225	B	UPVC	AS PER WSA-137
	45.49	M.H.	1050	B	CONC.	DTC-2203 (B-18.03.15) DTC-2221 (B-01.03.13)
	51.98	M.S.	300	B	UPVC	WSA-137 (DN300 RISER USED ON HIGH LEVEL CONNL. MS'S)
	115.92	M.S.	300	B	UPVC	WSA-137 (DN300 RISER USED ON HIGH LEVEL CONNL. MS'S)
	163.80	M.H.	1050	B	CONC.	DTC-2203 (B-18.03.15) DTC-2221 (B-01.03.13)
	197.25	M.S.	225	B	UPVC	AS PER WSA-137
	233.43	T.M.S.	225	B	UPVC	AS PER WSA-137
2	22.88	M.S.	300	B	UPVC	WSA-137 (DN300 RISER USED ON HIGH LEVEL CONNL. MS'S)
	32.52	M.S.	300	B	UPVC	WSA-137 (DN300 RISER USED ON HIGH LEVEL CONNL. MS'S)
	57.97	M.S.	225	B	UPVC	AS PER WSA-137
	68.05	M.S.	225	B	UPVC	AS PER WSA-137
	78.49	M.S.	300	B	UPVC	WSA-137 (DN300 RISER USED ON HIGH LEVEL CONNL. MS'S)
	106.73	M.H.	1050	B	CONC.	DTC-2203 (B-18.03.15) DTC-2221 (B-01.03.13)
	146.05	M.S.	225	B	UPVC	AS PER WSA-137
	153.25	T.M.S.	225	B	UPVC	AS PER WSA-137
3	5.74	T.M.S.	225	B	UPVC	AS PER WSA-137
4	00	M.S.	225	B	UPVC	AS PER WSA-137
	49.58	M.S.	225	B	UPVC	AS PER WSA-137
	105.42	M.H.	1050	B	CONC.	DTC-2203 (B-18.03.15) DTC-2221 (B-01.03.13)
	150.68	M.S.	225	B	UPVC	AS PER WSA-137
	197.12	M.S.	225	B	UPVC	AS PER WSA-137
	231.18	T.M.S.	225	B	UPVC	AS PER WSA-137

No.	AMENDMENT DESCRIPTION	BY	DATE
0	WORK AS CONSTRUCTED	J.V.	14.05.20
E	SYDNEY WATER CHANGES	M.P.	08.10.19
D	STEEP GRADES REDUCED	M.P.	10.09.19
C	NOTE 12 OFFSET CHANGED TO 1M	M.P.	19.07.19
B	LOT LAYOUT REVISED	M.P.	08.11.18
A	DRAFT	M.P.	02.11.18

WORK AS CONSTRUCTED CERTIFICATION		Sydney WATER SYDNEY WATER CORPORATION	
DEVELOPER	LEPRO PTY LTD	Case No. 174096WW SHT 4 OF 4 SHTS.	
W.S.C.	QALCHEK PTY LTD		
CONSTRUCTOR	FLUID SERVICES PTY LTD	SYDNEY WATER CORPORATION FOR DETAILS OF SERVICES SEE SHEET 1	
COMPLETED	11.05.2020		
W.A.C. PREPARED	14.05.2020		
DESIGNER	QALCHEK PTY LTD		
I CERTIFY THAT THE WORKS HAVE BEEN CONSTRUCTED IN ACCORDANCE WITH THE WORK AS CONSTRUCTED DRAWINGS			